

# PLW 6 INSTALLATION INSTRUCTIONS

For Concrete, Cinder Block, Brick Mounting: Use Lag Bolt Expansion Shield - Bolt Size  $5/16"$  x  $1-1/2"$  Long  
For Wood Mounting: Lag Screws  $5/16"$  x  $1-1/2"$  Long (supplied)

- 1) Remove phone from unit by unscrewing the six (6) tamper resistant front panel screws (tool provided). Then unplug phone line connector and emergency button external output connector.
- 2) Remove  $3/8-16$  x  $1"$  Hex bolt from back section; lift off front cover.
- 3) Back Half (A) must be mounted  $34 \frac{9}{16}"$  inches above ground  $37 \frac{9}{16}"$  to mounting hole for ADA phone compliance. (see diagram).
- 4) Back half is attached to mounting surface using (4)  $5/16$  x  $1 \frac{1}{2}"$  lag bolts and (4)  $5/16"$  flat washers supplied.
- 5) Front cover (B) is attached by placing top of cover  $3/4"$  over top of back half and sliding down. Re-install (1)  $3/8-16$  x  $1"$  Hex bolt, to lock front to back.
- 6) Re-install phone.

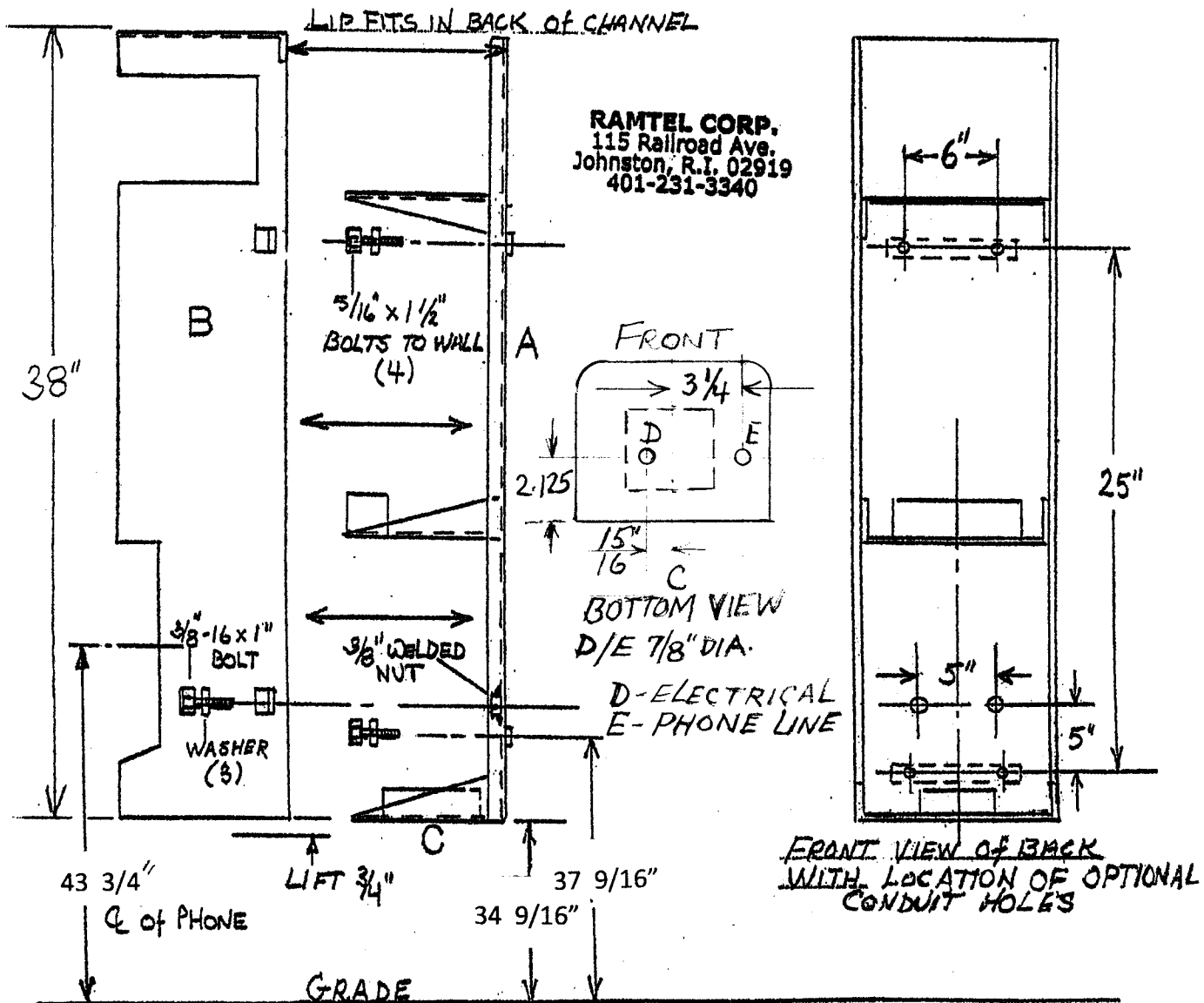

8/12/16 RAM